

Testing Facilities

Dynamic Mechanical Analyzer DMA 850

- Temperature Range: -160°C to 600°C
- Force: 0.0001 to 18 N

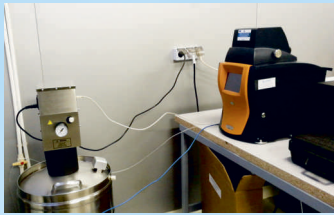

Thermomechanical Analyzer TMA 450

- Temperature Range: -150°C to 1000°C
- Heating rate: 0.01 to 150°C/min



Flash Diffusivity Analyzer DISCOVERY XENON FLASH DXF 900

- Temperature Range: -150°C to 900°C
- Thermal Diffusivity Range: 0.01 to 1000 mm²/s



Differential Scanning Calorimetry DSC 8500

- Temperature Range: -180°C to 750°C



Instron 8802 hydraulic mechanical testing machine

- Dynamic Load Capacity: 250kN static/dynamic



Instron Dynatup 9250NV Impact drop weight tower

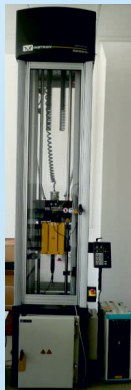

Composite Materials Laboratory for Aeronautic Field



COMOTI
ROMANIAN RESEARCH & DEVELOPMENT INSTITUTE FOR GAS TURBINES

Address: 220D Iuliu Maniu Ave.,
061126 Bucharest 6, ROMANIA, P.O. 76, P.O.B. 174
Phone: 0040 21/434.01.98, 0040 21/434.02.31, 0040 21/434.02.40
Fax: 0040 21/434.02.41
e-mail: contact@comoti.ro

www.comoti.ro

Contact person:

Dr. Eng. Raluca MAIER
e-mail: raluca.voicu@comoti.ro
Tel.: (+4)021-434 01 98/423, Fax: 021-434 02 41
Mobile: (+4)0720 499 875; (+4)0726 943 114



COMOTI
ROMANIAN RESEARCH & DEVELOPMENT INSTITUTE FOR GAS TURBINES



Research and development activities related to Aircraft Gas Turbines

Composite Materials Laboratory for Aeronautic Field

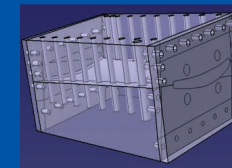
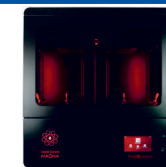

Complete Part Technological Development Cycle:

- Geometry-design;
- 3D CAD modelling;
- Structural architecture;
- Materials selection & laboratory characterization (microstructure, mechanic, thermal, environmental, aging etc.);
- Numerical analysis (CFD, CAA, stress analysis);

- Mould design & manufacturing;
- Technological protocol;
- Manufacturing of the full scale parts;
- 3D dimensional control (e.g. tolerances);
- Experimental test bench (in different regimes) for performances validation.

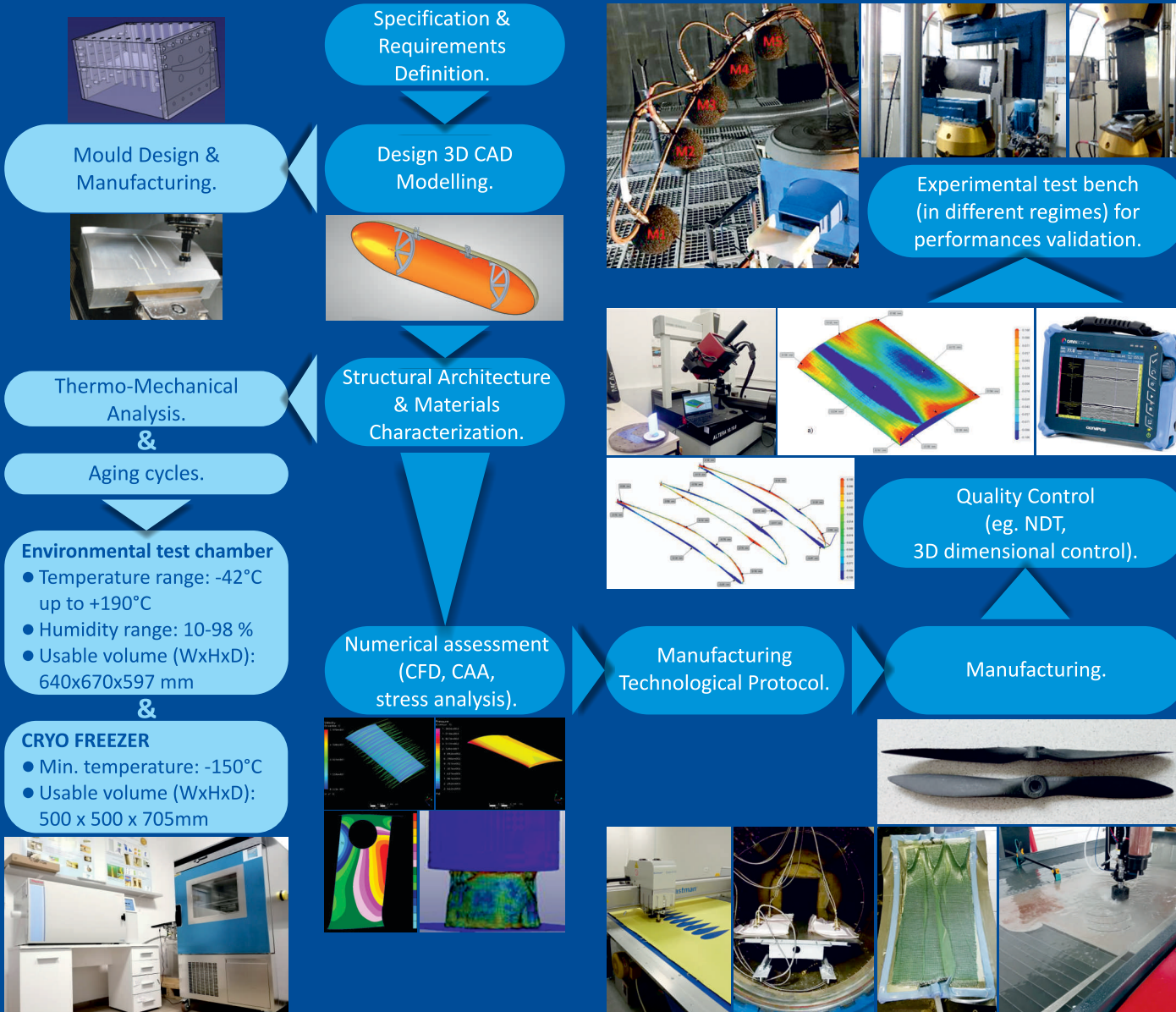

Material Development Facilities



Autoclave

- Temperature: max. 400°C
- Pressure: max. 20 bars
- Usable diameter: 1500 mm
- Usable length: 2500 mm



VA-RTM

Markforged X7 – CFF Additive manufacturing technology

Build volume: 330 x 270 x 200 mm



Liquid Crystal Magna – LCD Additive manufacturing technology

Build volume: 510 x 280 x 350mm

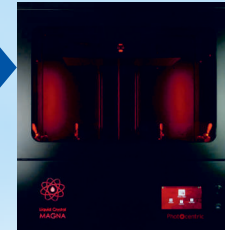

3 & 5 AXIS CNC Milling Machine

Pre-impregnated automatic cutting machine

Active cutting dimensions:
1.31 x 2.44 m (W x L)



Water jet cutting machine

- Processing dimensions:
- X-axis: 2900 max 3100 mm
 - Y axis: 1400 max 1600 mm
 - Z axis: 200 mm

Clean Room class 8 acc. ISO 14644 (for material processing)

